

# MASON-LITE

by MFI • Masonry Fireplace Industries, Inc.

*Manufacturers of Modular Masonry*

## 2025

### Pricing

### &

### Ordering Information

Revision 12/6/2024 Effective 1/1/2025

---

Phone: 951-588-6816

Toll Free: 800-345-7078

Fax: 951-588-8046

[www.mason-lite.com](http://www.mason-lite.com)

[info@mason-lite.com](mailto:info@mason-lite.com)

**Location:**

Po Box 4338

Riverside, Ca 92514



## Mason-Lite Standard Fire Boxes



Crated Package

- Standard kits come complete with mortar, Angle Iron or T-Bar. Linear, Regal and Custom units DO NOT include angle iron or T-Bar  
 - Sizes listed are raw box dimensions. Finished dimensions are 3" less when lined with fire brick splits or panels. (Linear and Regal Models reflect actual finished opening)

<b>Mason-Lite Wood Burning or Gas Firebox Kits (High Temp. Mortar Included)</b>		<b>RETAIL Price/Ea</b>	<b>Crated Weight (Lbs.)</b>
MFP75	75" SEMI-CUSTOM FIREBOX KIT, Use Dual 14" Class A UL103 Chim	\$11,698	2825
MFP63	63" FIREBOX KIT - Use 16" Class A UL103 Chimney	\$8,031	2652
MFP49	49" FIREBOX KIT - Use 14" Class A UL103 Chimney	\$5,450	1958
MFP44	44" FIREBOX KIT - Use 12" Class A UL103 Chimney	\$5,057	1757
MFP39	39" FIREBOX KIT - Use 12" Class A UL103 Chimney	\$4,668	1614
MFPST43	43" ST FIREBOX KIT - Use 16" Class A UL103 Chimney	\$6,061	1631
MFP33	33" FIREBOX KIT - Use 12" Class A UL103 Chimney	\$3,447	1337



## Mason-Lite Regal Wood Burning Boxes

Must use full firebrick sourced locally, Please note instruction manual for clearance differences

T-Bar/ Angle Iron Not Included

<b>Mason-Lite Regal Wood Burning Boxes</b>		<b>RETAIL Price/Ea</b>	<b>Crated Weight (Lbs.)</b>
MFP72-RGL	72" x 38.5" FIREBOX KIT - Use Dual 14" Class A UL103 Chimney	\$13,451	3385
MFP84-RGL	84" x 38.5" FIREBOX KIT - Use Dual 16" Class A UL103 Chimney	\$15,694	3794
MFP96-RGL	96" x 38.5" FIREBOX KIT - Use Dual 16" Class A UL103 Chimney	\$17,936	4185
MFP108-RGL	108" x 38.5" FIREBOX KIT - Use Triple 14" Class A UL103 Chimney	\$20,178	4475
MFP120-RGL	120" x 38.5" FIREBOX KIT - Use Triple 14" Class A UL103 Chimney	\$22,420	4900

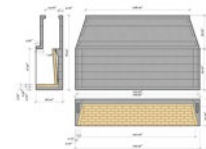

## Mason-Lite Standard B-Vent Fire Boxes Gas Burning Only

T-Bar Included

Burner, Logset and Spill Switch included. Comes Standard as NG, LP avail. upon request

### Gas B-Vent Firebox Kits

			Crated Weight (Lbs.)
MGFPST43	12" B-VENT GAS APPLIANCE w/ 30" NG Virginia Gas Logs	\$12,361	1881
MGFP49	10" B-VENT GAS APPLIANCE w/ 36" NG Virginia <b>Lucent</b> Gas Logs	\$11,257	2158
MGFP44	10" B-VENT GAS APPLIANCE w/ 30" NG Virginia <b>Lucent</b> Gas Logs	\$10,269	1932
MGFP39	10" B-VENT GAS APPLIANCE w/ 24" NG Virginia <b>Lucent</b> Gas Logs	\$9,367	1764



## Mason-Lite Standard Vent Free Fire Boxes Gas Burning Only

T-Bar Included

### Vent Free Firebox Kits

			Crated Weight (Lbs.)
MFP49VF	49" VENT FREE FIREBOX KIT - use any approved VF log set	\$4,463	1608
MFP44VF	44" VENT FREE FIREBOX KIT - use any approved VF log set	\$4,013	1457
MFP39VF	39" VENT FREE FIREBOX KIT - use any approved VF log set	\$3,533	1349
MFPST43VF	43" VENT FREE ST FIREBOX KIT - use any approved VF log set	\$4,386	1314

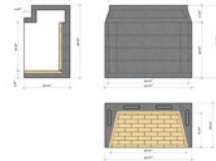

## Custom Mason-Lite Fireplaces Available



Design services available for custom fireplaces including linear, Rumford Style\*, See Thru, 3-sided, island and corner configuration. These custom units are ready to assemble and require little to no further modification on site. Please visit [Mason-Lite.com/customorder](http://Mason-Lite.com/customorder)

Pricing Effective January 1st, 2025

# Mason-Lite Accessories

## Combustion Air Kits

- Includes a closable fire box inlet (that fits pre-cut hole in firebox), 3' flexible vent conduit and plastic outdoor hood
- If using panels, a hole must be cut to accommodate the air kit. See complete instructions for further
- Square Sided (Linear or Custom) units require a "See Thru" Airkit.

RETAIL  
Price/Ea Weight

MFP4-AK-M	4" Combustion Air Kit -3' Flexible Vent and Metal Hood	\$349	7 lbs
MFPST-AK-M	4" Combustion Air Kit for MFPST43 AND Linear Units	\$349	7 lbs



## Fireplace Tools

MFPT-DTP-R	Deluxe Drop Tine Fire Poker Fireplace Tool- Right Handed	\$278	5 lbs
MFPT-DTP-L	Deluxe Drop Tine Fire Poker Fireplace Tool- Left Handed	\$278	5 lbs



## Masonry Arches

- This option must be cut to size and fitted in per installation instructions.

MFP-ARC	Masonry Arch - Fits up to and including MFP49	\$416	42 lbs
MFP-ARC63	Masonry Arch - Fits MFP63 - NON-STOCK ITEM	\$652	60 lbs



## Refractory Mortar

MFP530	50 LBS. BUCKET DRY MORTAR	\$236	50 lbs
--------	---------------------------	-------	--------

## Height Kits (Used to increase opening height by 8") (Flue size may need to be increased)

- Includes firebox sections to increase face height by 8"
- Be sure to check flue sizing (diameter) based on the installation parameters (i.e.. chimney height and new face dimensions) to insure proper draw.

MFP75-HK	Height Kit Includes (1) MFP75-2, (1) MFP75-2A & (2) MFP75-3	\$1,421	279 lbs
MFP63-HK	Height Kit Includes (1) MFP63-2, (1) MFP63-2A & (2) MFP63-3	\$1,198	255 lbs
MFP49-HK	Height Kit Includes (1) MFP49-2 & (2) MFP49-3	\$710	239 lbs
MFP44-HK	Height Kit Includes (1) MFP44-2 & (2) MFP44-3	\$693	228 lbs
MFP39-HK	Height Kit Includes (1) MFP39-2 & (2) MFP39-3	\$664	219 lbs
MFPST43-HK	Height Kit Includes (2) MFP43ST-3	\$577	162 lbs
MFP33-HK	Height Kit Includes (1) MFP33-2 & (2) MFP33-3	\$629	215 lbs



## Metal Bases (For use with Wood Burning Fireplaces Being Installed on a Wood Floor)

- For installations on combustible floors.
- Includes Insulation Blanket, All Thread, Brackets and (2) Cement Board Per Base
- Additional mounting hardware may be required depending upon the installation. (See Instructions)

RETAIL  
Price/Ea Weight

MFPB63	8" Structural Metal Base for 63" Firebox	\$2,324	219 lbs
MFPB49	6" Structural Metal Base for 49" Firebox	\$1,856	140 lbs
MFPB44	6" Structural Metal Base for 44" Firebox	\$1,571	128 lbs
MFPB43	8" Structural Metal Base for 43" See-Thru Firebox	\$1,741	115 lbs
MFPB39	6" Structural Metal Base for 39" Firebox	\$1,431	103 lbs
MFPB33	6" Structural Metal Base for 33" Firebox	\$1,260	85 lbs



## Steel Throat Dampers (Designed For Mason-Lite Fireplaces) (Damper Blocks Not Necessary)

MFP-SD63	63" Steel Throat Damper - for MFP63 (DAMPER BLOCK - NOT NECESSARY)	\$1,538	109 lbs
MFP-SD49	49" Steel Throat Damper - for MFP49 (DAMPER BLOCK - NOT NECESSARY)	\$726	89 lbs
MFP-SD44	44" Steel Throat Damper - for MFP44 (DAMPER BLOCK - NOT NECESSARY)	\$645	82 lbs
MFP-SD39	39" Steel Throat Damper - for MFP39 (DAMPER BLOCK - NOT NECESSARY)	\$575	75 lbs
MFP-SD33	33" Steel Throat Damper - for MFP33 (DAMPER BLOCK - NOT NECESSARY)	\$506	60 lbs



## Cast Iron Dampers (Based on Availability)

MFP-CC54	54" Cast Damper - for MFP63 (DAMPER BLOCK - MFP63 Included)	\$1,468	109 lbs
MFP-CC42	42" Cast Damper - for MFP49 (DAMPER BLOCK - MFP49 Included)	\$627	89 lbs
MFP-CC36	36" Cast Damper - for MFP44 (DAMPER BLOCK - MFP44 Included)	\$549	82 lbs
MFP-CC30	30" Cast Damper - for MFP39 (DAMPER BLOCK - MFP39 Included)	\$487	75 lbs
MFP-CC24	24" Cast Damper - for MFP33 (DAMPER BLOCK - MFP33 Included)	\$375	60 lbs



## Damper Blocks (If using Mason-Lite Firebrick Panels, Damper Blocks are not needed)

MFPDS63	Damper Block for MFP63	\$193	57 lbs
MFPDS49	Damper Block for MFP49	\$165	44 lbs
MFPDS44	Damper Block for MFP44	\$148	40 lbs
MFPDS39	Damper Block for MFP39	\$128	36 lbs
MFPDS33	Damper Block for MFP33	\$109	31 lbs

## PureBurn EPA Phase II Qualified Burner

QWBN-44	PUREBURN GRATE/BURNER SET (Natural Gas) (for MFP44 and MFP49 )	\$2,703	18 lbs
QWBP-44	PUREBURN GRATE/BURNER SET (Propane) (for MFP44 and MFP49 )	\$2,703	18 lbs
QWBN-33	PUREBURN GRATE/BURNER SET (Natural Gas) (for MFP33 and MFP39 )	\$2,026	14 lbs
QWBP-33	PUREBURN GRATE/BURNER SET (Propane) (for MFP33 and MFP39 )	\$2,026	14 lbs
QWBN-63	PUREBURN GRATE/BURNER SET (Natural Gas) (for MFP63 )	\$3,869	26 lbs
QWBP-63	PUREBURN GRATE/BURNER SET (Propane) (for MFP63 )	\$3,869	26 lbs
QWB-EI	ELECTRONIC IGNITION FOR USE WITH PUREBURN UNITS	\$585	3 lbs



Phone: 951-588-6816

www.Mason-Lite.com

Toll Free: 800-345-7078

info@Mason-lite.com

Fax: 951-588-8046

Page 5

Po Box 4338  
Riverside, Ca 92514

Pricing Effective January 1st., 2025

## Mason-Lite Real Brick Panels & Fire Brick

- Made with real Fire Brick and are available for fire boxes ordered with the optional height kit. Add 20 % to price. Designate extended height panels by adding -X to the part number (ex. MFP39SHBL-X). Extended panels only available for use with one height extension.

- Panels come standard in Gold Color. (Original Buff Color). Panels also available in Cream and Black. Designate Cream brick by adding -C to the part number (ex. MFP39SHBL-C).

- Designate Black brick by adding -B to the part number (ex.MFP39SHBL-B .

Brick Panels not available for Linear or Regal models. (Color may vary between sets) (Not available for MFP75)(Standard Color is Gold)

		RETAIL	
		Price/Ea	Weight
<b>Split Herringbone Brick Panels (Brick Size Approx. 2.25" x 9")</b>			
MFP63SHBL-G	Herringbone Brick Panels for 63" FP	\$4,425	563 lbs
MFP49SHBL-G	Herringbone Brick Panels for 49" FP	\$3,007	474 lbs
MFP44SHBL-G	Herringbone Brick Panels for 44" FP	\$2,867	418 lbs
MFP39SHBL-G	Herringbone Brick Panels for 39" FP	\$2,703	395 lbs
MFP33SHBL-G	Herringbone Brick Panels for 33" FP	\$2,419	334 lbs
MFPST43SHBL-G	Herringbone Brick Panel for 43" See-Thru FP	\$3,007	412 lbs



Split Herringbone

<b>Split Running Bond Brick Panels (Brick Size Approx. 2.25" x 9")</b>			
MFP63SRBL-G	Split Running Bond Brick Panels for 63" FP	\$4,425	563 lbs
MFP49SRBL-G	Split Running Bond Brick Panels for 49" FP	\$3,007	474 lbs
MFP44SRBL-G	Split Running Bond Brick Panels for 44" FP	\$2,867	418 lbs
MFP39SRBL-G	Split Running Bond Brick Panels for 39" FP	\$2,703	395 lbs
MFP33SRBL-G	Split Running Bond Brick Panels for 33" FP	\$2,419	334 lbs
MFPST43SRBL-G	Split Running Bond Brick Panel for 43" See-Thru FP	\$3,007	412 lbs



Split Running Bond  
(shown in Black)

<b>Full Running Bond Brick Panels (Brick Size Approx. 4.5" x 9")</b>			
MFP63FRBL-G	Full Running Bond Brick Panels for 63" FP	\$4,153	602 lbs
MFP49FRBL-G	Full Running Bond Brick Panels for 49" FP	\$2,703	498 lbs
MFP44FRBL-G	Full Running Bond Brick Panels for 44" FP	\$2,596	448 lbs
MFP39FRBL-G	Full Running Bond Brick Panels for 39" FP	\$2,458	430 lbs
MFP33FRBL-G	Full Running Bond Brick Panels for 33" FP	\$2,207	364 lbs
MFPST43FRBL-G	Full Running Bond Brick Panel for 43" See-Thru FP	\$2,703	414 lbs



Full Running Bond

*Cream and Black Colors also available. See above for details.*

		RETAIL	
		Price/Ea	Weight
<b>EXTENDED Split Herringbone Brick Panels (Brick Size Approx. 2.25" x 9")</b>			
MFP63SHBL-G-X	8" Extended Herringbone Brick Panels for 63" Fireplace w. Height Kit	\$5,310	676 lbs
MFP49SHBL-G-X	8" Extended Herringbone Brick Panels for 49" Fireplace w. Height Kit	\$3,609	569 lbs
MFP44SHBL-G-X	8" Extended Herringbone Brick Panels for 44" Fireplace w. Height Kit	\$3,441	502 lbs
MFP39SHBL-G-X	8" Extended Herringbone Brick Panels for 39" Fireplace w. Height Kit	\$3,244	474 lbs
MFP33SHBL-G-X	8" Extended Herringbone Brick Panels for 33" Fireplace w. Height Kit	\$2,903	401 lbs
MFPST43SHBL-G-X	8" Extended Herringbone Brick Panels for 43" See Thru Fireplace w. HK	\$3,609	494 lbs

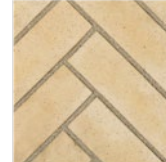

Split Herringbone

<b>EXTENDED Split Running Bond Brick Panels (Brick Size Approx. 2.25" x 9")</b>			
MFP63SRBL-G-X	8" Extended Split Running Bond Brick Panels for 63" FP w. Height Kit	\$5,310	676 lbs
MFP49SRBL-G-X	8" Extended Split Running Bond Brick Panels for 49" FP w. Height Kit	\$3,609	569 lbs
MFP44SRBL-G-X	8" Extended Split Running Bond Brick Panels for 44" FP w. Height Kit	\$3,441	502 lbs
MFP39SRBL-G-X	8" Extended Split Running Bond Brick Panels for 39" FP w. Height Kit	\$3,244	474 lbs
MFP33SRBL-G-X	8" Extended Split Running Bond Brick Panels for 33" FP w. Height Kit	\$2,903	401 lbs
MFPST43SRBL-G-X	8" Extended Split Running Bond Brick Panel for 43" See-Thru FP w. HK	\$3,609	494 lbs



Split Running Bond  
(shown in Black)

<b>EXTENDED Full Running Bond Brick Panels (Brick Size Approx. 4.5" x 9")</b>			
MFP63FRBL-G-X	8" Extended Full Running Bond Brick Panels for 63" FP w. Height Kit	\$4,984	722 lbs
MFP49FRBL-G-X	8" Extended Full Running Bond Brick Panels for 49" FP w. Height Kit	\$3,244	598 lbs
MFP44FRBL-G-X	8" Extended Full Running Bond Brick Panels for 44" FP w. Height Kit	\$3,115	538 lbs
MFP39FRBL-G-X	8" Extended Full Running Bond Brick Panels for 39" FP w. Height Kit	\$2,949	516 lbs
MFP33FRBL-G-X	8" Extended Full Running Bond Brick Panels for 33" FP w. Height Kit	\$2,649	436 lbs
MFPST43FRBL-C-X	8" Extended Full Running Bond Brick Panel for 43" See-Thru FP w. HK	\$3,244	496 lbs



Full Running Bond

*Extended Cream and Black Colors also available. See above for details.*

## Mason-Lite Firebrick by the Pallet

Firebrick by the Pallet (Color may vary between pallets)

		RETAIL	Weight
		Price/Ea	Approx.
<b>NOTE: Split size is not the same size as the brick in "split" brick panels above</b>			
MFP-FBPT-G	Pallet of 332 Gold Full Sized Firebrick (Approx. 4.5" x 9" x 2.5" Brick Size)	\$5,034	2536 lbs
MFP-SBPT-G	Pallet of 664 Gold Split Sized Firebrick (Approx. 4.5" x 9" x 1.25" Brick Size)	\$6,945	2536 lbs
MFP-FBPT-B	Pallet of 336 Black Full Sized Firebrick (Approx. 4.5" x 9" x 2.5" Brick Size)	\$5,034	2620 lbs
MFP-SBPT-B	Pallet of 648 Black Split Sized Firebrick (Approx. 4.5" x 9" x 1.25" Brick Size)	\$6,945	2620 lbs
MFP-FBPT-C	Pallet of 304 Cream Full Sized Firebrick (Approx. 4.5" x 9" x 2.5" Brick Size)	\$5,034	2679 lbs
MFP-SBPT-C	Pallet of 1008 Cream Split Sized Firebrick (Approx. 4.5" x 9" x 1.25" Brick Size)	\$10,541	4117 lbs

Phone: 951-588-6816

Toll Free: 800-345-7078

Fax: 951-588-8046

www.Mason-Lite.com

info@Mason-lite.com

Page 6

Po Box 4338

Riverside, Ca 92514

## Mason-Lite Linear Fireboxes & Burners

"Trough" models conceal either our Opalescence Linear burner with LED light combo or Golden Blount's Alpine burner. For applications that require more burner flexibility, we offer the "No Trough" models. These models will accept traditional "H" Burners and Logsets.

**Linear B-Vent Firebox Kits (Use MFPST-AK if Outside Airkit is needed)**

		<b>RETAIL</b>	Crated Weight
LMFP36-NT	36" LINEAR GAS FIREPLACE (NO TROUGH) - 12" B-VENT	<b>\$7,493</b>	1758
LMFP48-NT	48" LINEAR GAS FIREPLACE (NO TROUGH) - 12" B-VENT	<b>\$9,272</b>	2056
LMFP60-NT	60" LINEAR GAS FIREPLACE (NO TROUGH) - 12" B-VENT	<b>\$10,437</b>	2293
LMFP72-NT	72" LINEAR GAS FIREPLACE (NO TROUGH) - 12" B-VENT	<b>\$15,180</b>	2633
LMFP84-NT	84" LINEAR GAS FIREPLACE (NO TROUGH) - 12" B-VENT	<b>\$17,245</b>	3030
LMFP96-NT	96" LINEAR GAS FIREPLACE (NO TROUGH) - Dual 12" B-VENT	<b>\$19,258</b>	3204
LMFP108-NT	108" LINEAR GAS FIREPLACE (NO TROUGH) - Dual 12" B-VENT	<b>\$21,043</b>	3440
LMFP120-NT	120" LINEAR GAS FIREPLACE (NO TROUGH) - Dual 12" B-VENT	<b>\$22,636</b>	3805
LMFP36	36" LINEAR GAS FIREPLACE - 12" B-VENT (with Burner Trough)	<b>\$8,291</b>	2134
LMFP48	48" LINEAR GAS FIREPLACE - 12" B-VENT (with Burner Trough)	<b>\$10,259</b>	2324
LMFP60	60" LINEAR GAS FIREPLACE - 12" B-VENT (with Burner Trough)	<b>\$11,554</b>	2757
LMFP72	72" LINEAR GAS FIREPLACE - 12" B-VENT (with Burner Trough)	<b>\$16,824</b>	3109
LMFP84	84" LINEAR GAS FIREPLACE - 12" B-VENT (with Burner Trough)	<b>\$19,117</b>	3344
LMFP96	96" LINEAR GAS FIREPLACE - Dual 12" B-VENT (with Burner Trough)	<b>\$21,345</b>	3699
LMFP108	108" LINEAR GAS FIREPLACE - Dual 12" B-VENT (with Burner Trough)	<b>\$23,328</b>	4118
LMFP120	120" LINEAR GAS FIREPLACE - Dual 12" B-VENT (with Burner Trough)	<b>\$25,098</b>	4565

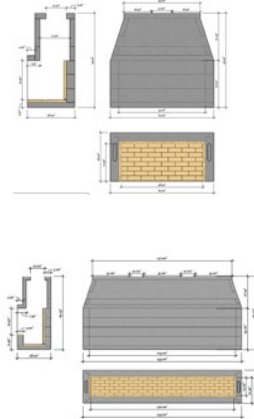

## Mason-Lite Linear VENT FREE Fireboxes & Burners

Mason Lite is here to meet your Linear Vent Free burner needs. We have designed our models to with a trough conceal our Opalescence Linear Vent Free burner with LED light combo.

### Linear Vent Free Firebox Kits

(Use MFPST-AK if Outside Airkirt is needed) (-NT Versions available upon request)

		RETAIL	Crated Weight
LMFP24-VF	24" LINEAR VENT FREE GAS FIREPLACE (with Burner Trough)	\$4,514	1547
LMFP36-VF	36" LINEAR VENT FREE GAS FIREPLACE (with Burner Trough)	\$5,891	1895
LMFP48-VF	48" LINEAR VENT FREE GAS FIREPLACE (with Burner Trough)	\$7,300	2056
LMFP60-VF	60" LINEAR VENT FREE GAS FIREPLACE (with Burner Trough)	\$8,261	2464

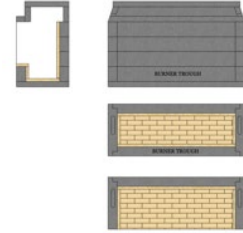



## Chimney Systems/Components for *Mason-Lite*

- Mason-Lite refractory chimney system may be used on MFP33, MFP39, MFP44 and MFP49 with a max. syst. hgt. of 30' without add. supp.
- The MFP5T43, MFP63 or and MFP75 would need to be ordered specially to use dual 14" Mas. Chim. and would have a max. syst. hgt. of 20'

### Mason-Lite Masonry Chimney System Kits

- MCLS-814K 8' System includes MCL-414 (1 ea.), MCL-814 (12 ea.), MCS-814 (12 ea.) & 50 lb. refractory mortar.
- MCLS-814P 4' System includes MCL-414 (1 ea.), MCL-814 (6 ea.), MCS-814 (6 ea.) & 50 lb. refractory mortar.

		RETAIL	Weight
MCLS-814-16K	Mason-Lite 16' System	\$3,035	2410 lbs
MCLS-814K	Mason-Lite 8' System	\$1,676	1225 lbs
MCLS-814P	Mason-Lite 4' Patio System	\$1,123	731 lbs

### Mason-Lite Masonry Chimney Individual Components

		RETAIL	Weight
MCL-814	Inner Liner (Individual) 14" ID x 8" H	\$67	32 lbs
MCS-814	Outer Liner (Individual) 8" H	\$81	61 lbs
MCL-414	Inner Liner Starter (Individual) 14" ID x 4" H	\$48	14 lbs
MCSBL-814	Brick Ledge 4" H - NON-STOCK	\$349	72 lbs
MCSOS-814	Offset Elbow (30 Degrees) 14" ID x 4" H	\$224	90 lbs
MCL-CAP	Mason-Lite Chimney Cap	\$266	12 lbs
MCL-CAP-SS	Mason-Lite Chimney Cap Stainless Steel	\$388	8 lbs
MCL-CAP-C	Mason-Lite Chimney Cap Copper	\$1,200	8 lbs
MCS-CWN	Mason-Lite Chimney Crown	\$546	95 lbs
MC14-AP	14" ANCHOR PLATE/DAMPER - USE WITH MAS. CHIM. ONLY	\$369	15 lbs

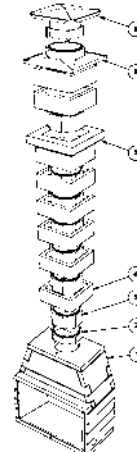

## Mason-Lite Pizza Ovens

### Mason-Lite Masonry Pizza Oven

		RETAIL	Weight
MPO-18	18" Toscana Pizza Oven - Inc. 16" Tall Mas. Chim., Firebrick Panels	\$2,811	625 lbs
MPO-18WS	Toscana Pizza Oven Wood Storage	\$2,208	588 lbs
MPO-18D	Toscana Pizza Oven Door	\$991	18 lbs
MPO-24	24" Toscana Golia Pizza Oven - Inc. 16" Tall Mas. Chim., Firebrick Panels	\$6,278	1699 lbs
MPO-24WS	Toscana Golia Oven Wood Storage	\$4,030	1161 lbs
MPO-24D	Toscana Golia Pizza Oven Door	\$1,578	35 lbs



## Mason-Lite Fire Features

### Mason-Lite Square Fire Features

		RETAIL	Weight
FFS36	36" Square Fire Feature	\$1,379	TBD
FFS42	42" Square Fire Feature	\$1,729	TBD
FFS48	48" Square Fire Feature	\$2,079	TBD

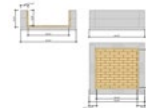

### Mason-Lite Linear Fire Features

		RETAIL	Weight
FFL36	36" Linear Fire Feature	\$1,449	TBD
FFL48	48" Linear Fire Feature	\$1,799	TBD
FFL60	60" Linear Fire Feature	\$2,253	TBD
FFL72	72" Linear Fire Feature	\$2,707	TBD
FFL96	96" Linear Fire Feature	\$3,615	TBD
FFL120	120" Linear Fire Feature	\$4,523	TBD

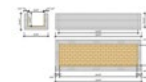

Fire Feature Brick Panels and Caps Coming Soon